

## BIRDSVILLE 260

Country  
Range



House Width	<b>30.11</b>
House Length	<b>17.35</b>
Dwelling	<b>242.69</b>
Garage	<b>53.58</b>
Alfresco	<b>25.80</b>
Porch	<b>7.30</b>
Verandah	<b>24.73</b>
Total	<b>354.10</b>

### Facades Options.

\*Please Discuss with your Sales Consultant.

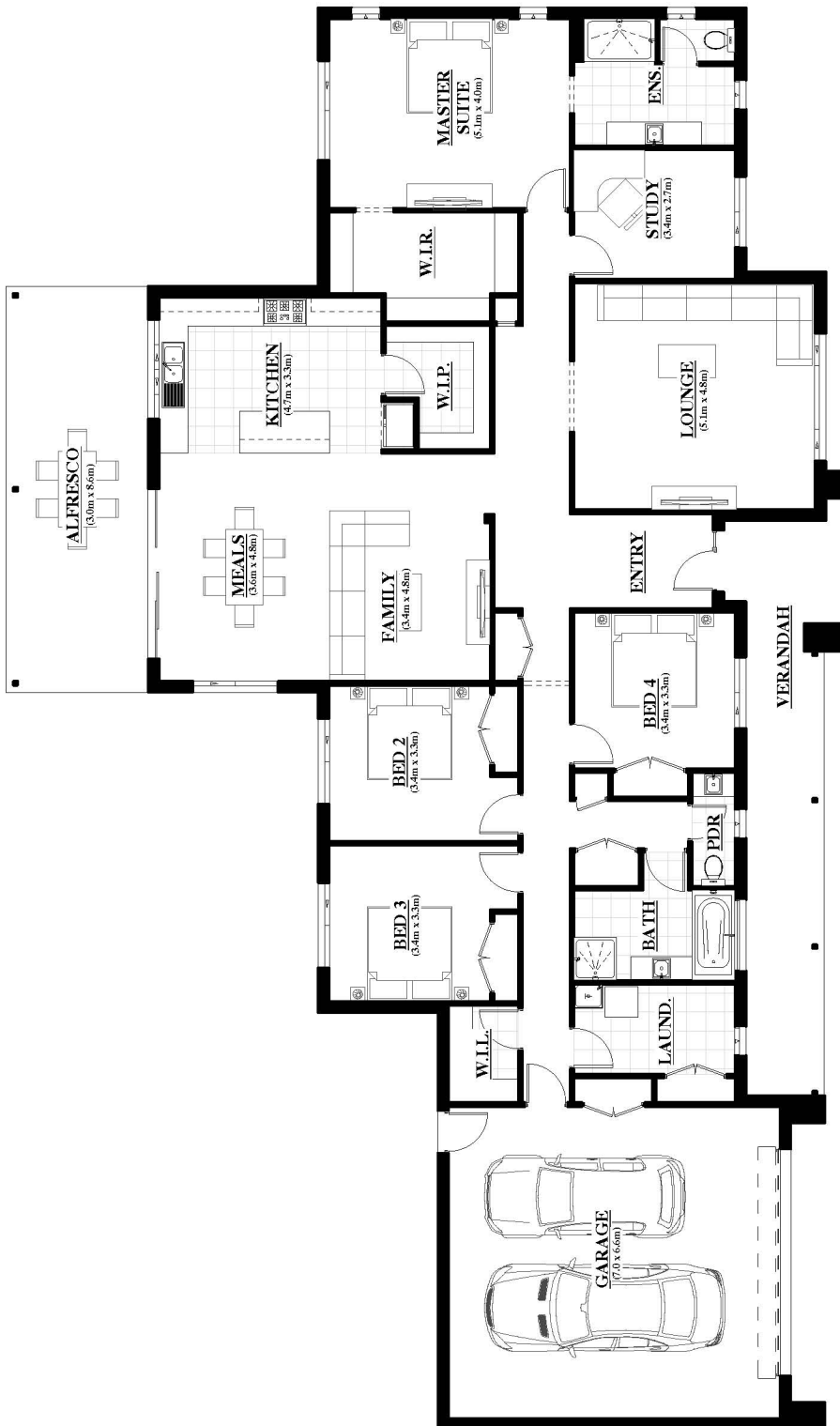

### Facades Options.

\*Please Discuss with your Sales Consultant.



**COLMAC HOMES**

Country Range  
**BIRDSVILLE 260**